

# Hydro-Pro 150QC® Quick Connect Spray Nozzle

The **Hydro-Pro 150QC®** has a revolutionary nosepiece designed for easy ¼ turn movement to connect and disconnect special Quick Connect attachments. Can be used with or without accessories!

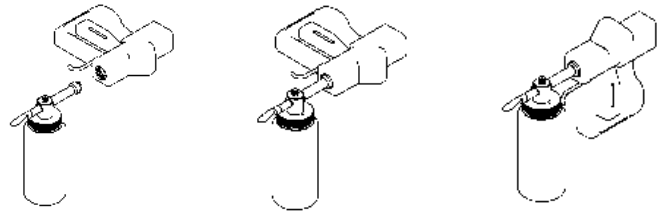

## Specifications

- ♦ **Maximum recommended operating pressure** ..... 200°F/93°C
- ♦ **Maximum working pressure**..... 150 psi
- ♦ **Flow rates:** ..... 5-7 gpm (50-80 psi);  
10 gpm maximum  
at 150 psi
- ♦ Available: black, white or red cover
- ♦ Available with or without swivel adapter

**NOTE:** Intended for water use only.  
Not suitable for steam service.

## Features

- ♦ Plastic 16 oz. bottle or 2 gallon container for safe, convenient, targeted applications of soaps and disinfectants
- ♦ 6," 24" and 36" stainless steel extension wand for concentrated directional spray
- ♦ Stainless steel deflector tip on container attachments ensures spray direction
- ♦ Operating temperature, pressure and flow rates are the same as the original Hydro-Pro spray nozzle



**Shown:** Black *Hydro-Pro 150* with 16 oz. bottle



**USA Headquarters**

2801 Baglyos Circle ♦ Bethlehem, PA 18020

Phone: (484) 893-5080 ♦ Fax: (484) 893-5099 ♦ Toll Free: (877) STRAHMAN

**[www.strahmanvalves.com](http://www.strahmanvalves.com)**

### France

Savoie Hexapole, F-73420 Mery, France  
Tel: 33 (0) 4 79 35 78 00  
Fax: 33 (0) 4 79 35 78 20

### Germany

Zum Schwarzhof 14, 77704, Oberkirch, Germany  
Tel: 49 (0) 7802 - 7037879  
Fax: 49 (0) 7802 - 7037889

# Hydro-Pro 150QC® Quick Connect Spray Nozzle

The **Hydro-Pro 150QC®** spray nozzle is specially designed to accept any of the Quick Connect attachments with a simple ¼ turn to connect and disconnect for safe and convenient cleaning! Same great performance as the original **Hydro-Pro 150** Spray Nozzle.



*Shown: Red Hydro-Pro 150 with extension*

## Specifications

- ♦ **Maximum recommended operating pressure** ..... 200°F/93°C
- ♦ **Maximum working pressure**..... 150 psi
- ♦ **Flow rates:** ..... 5-7 gpm (50-80 psi);  
10 gpm maximum  
at 150 psi
- ♦ Available: black, white or red cover
- ♦ Available with or without swivel adapter

**NOTE:** Intended for water use only.  
Not suitable for steam service.

## Quick Connect Accessories

- ♦ 2 gallon soap reservoir bottle
- ♦ 6" extension wand with 16 oz. bottle
- ♦ 6" extension wand with interchangeable heads (adjustable and chisel type)
- ♦ 24" extension wand, straight flow only
- ♦ 36" extension wand with interchangeable heads (adjustable and chisel type)



*Shown: 2 gallon container attachment*



**USA Headquarters**

2801 Baglyos Circle ♦ Bethlehem, PA 18020

Phone: (484) 893-5080 ♦ Fax: (484) 893-5099 ♦ Toll Free: (877) STRAHMAN

[www.strahmanvalves.com](http://www.strahmanvalves.com)

### France

Savoie Hexapole, F-73420 Mery, France  
Tel: 33 (0) 4 79 35 78 00  
Fax: 33 (0) 4 79 35 78 20

### Germany

Zum Schwarzhof 14, 77704, Oberkirch, Germany  
Tel: 49 (0) 7802 - 7037879  
Fax: 49 (0) 7802 - 7037889